

Solid Operable Wall

BOZ Series | CLAZ Series | ECOS Series

Envision your space with limitless possibilities, and we shall transform. It owns great flexibility to change, whether it's opening, closing or dividing your space, any way to maximize efficiency.

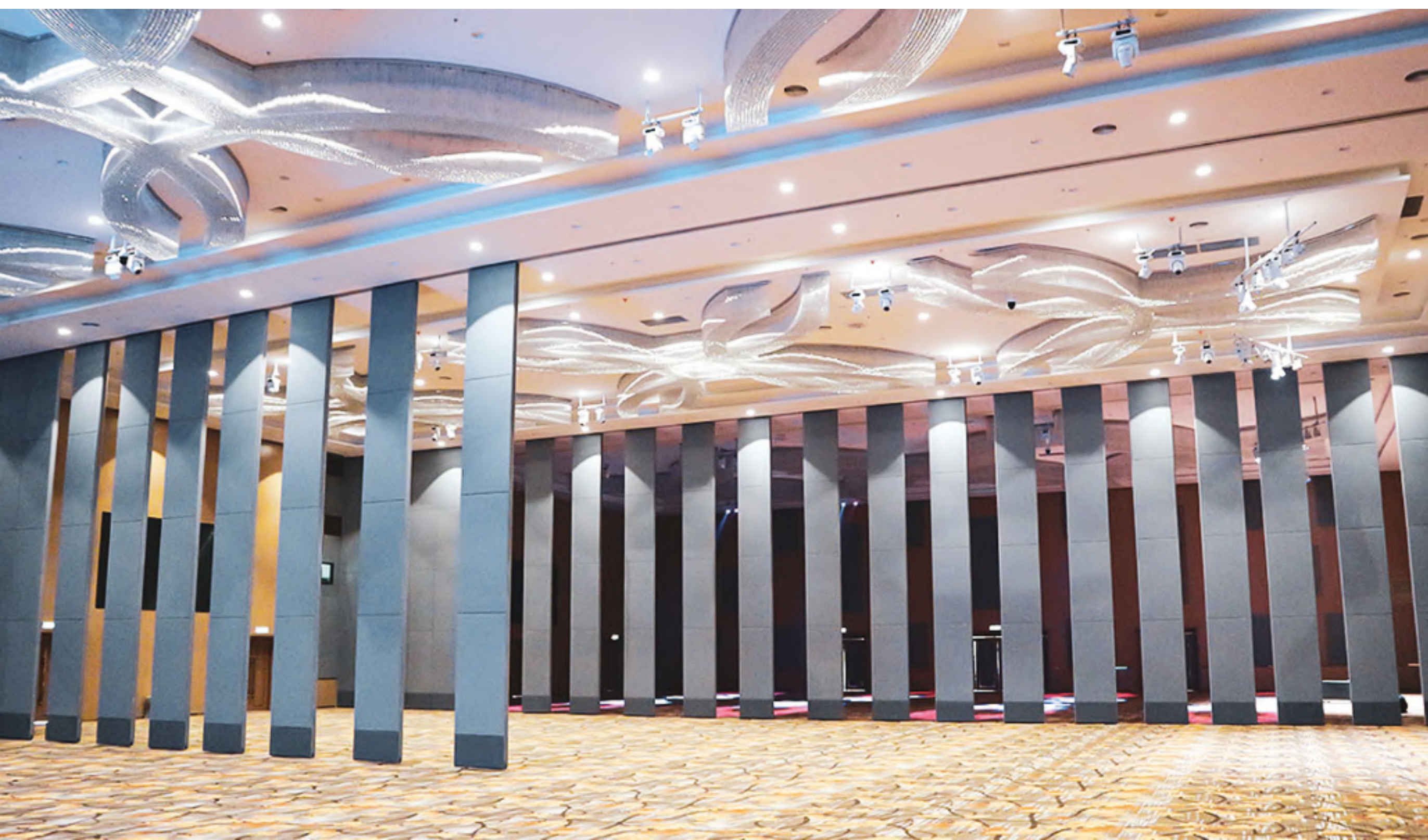



Fast Setup

Effectiveness is significant to us. We employ Fast-Set seal system which requires minimum setting-up time.



User-friendly

Our heavy duty track and carrier system is made easy for anyone to operate smoothly and easily.



Long Lifespan

Crafted with superior quality materials for an outstanding finish, providing long usage & minimum deterioration.



High Acoustic Rating

We use the latest technology of sound absorption to provide an experience of world-class acoustics.



Vast Finishing Selections

We offer a wide range of factory choices for the panel surface finishes.



BOZ Series



**Made for GRAND. MEGA.
MAGNIFICENT spaces.**

Designed for high wall and ceiling with the highest acoustic performance from all series (up to STC 51). A perfect suit for hotel ballroom, exhibition hall, convention center, and rooms that require high acoustic reduction.

Panel Specifications

Thickness	100mm
Width	700mm ~ 1200mm
Height	1500mm ~ 10000mm*
Suspension	Top Hang with Single or Double Carrier
Acoustic Seal	Fast-Set Top & Bottom Retractable seal
Acoustic Performance	STC 43 ~ 51 dB
Options	Single / Double Leaf Pass Door

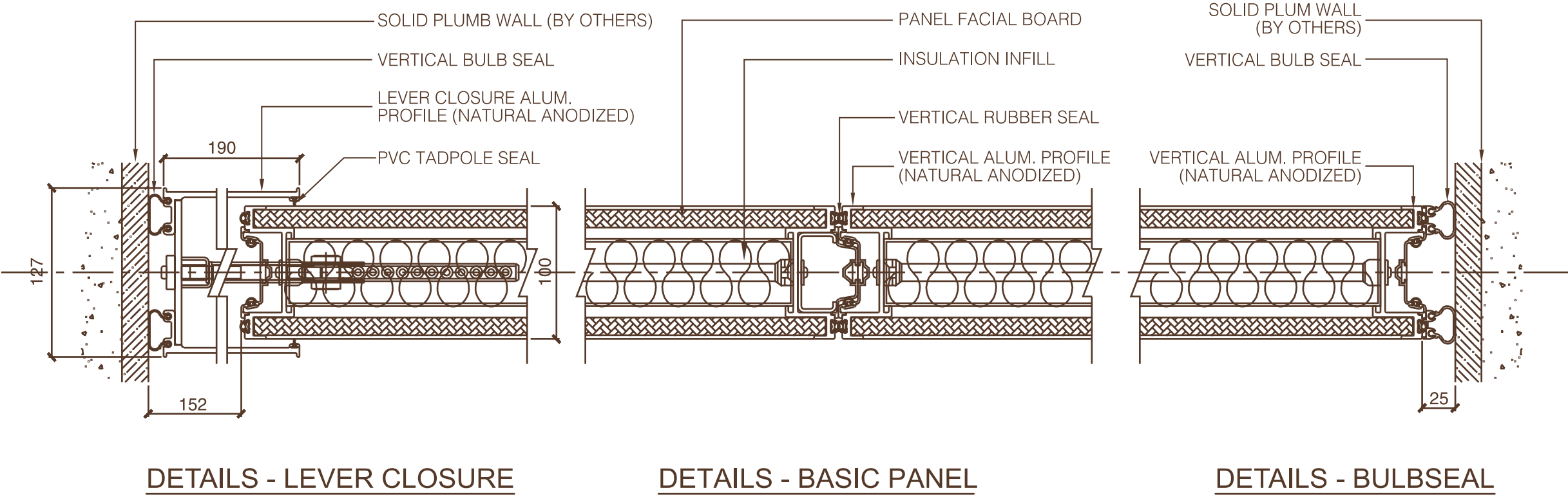
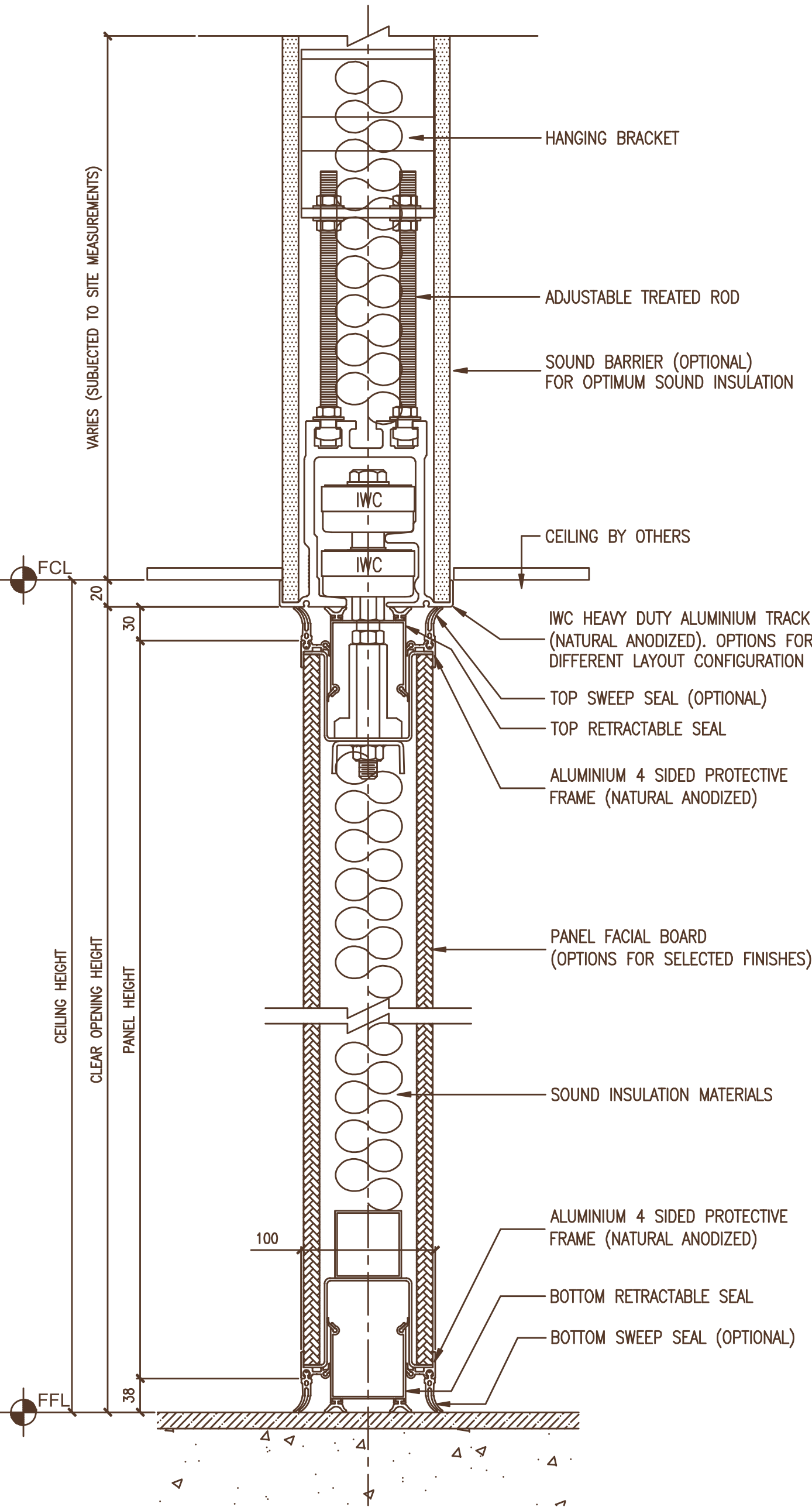

Track Options:
Type #D450, #D670, #D1300, #S300
** Consult factory for panel exceeding 10000mm height*
***IWC ASIA reserves the rights to change and improvise the product without prior notice.*





Panel Construction

- Panels' nominal thickness are 100mm thick.
- Face boards with options of 12mm thick particle board/Gypsum board/MDF board infilled with sound insulation materials and options of different surface substances to meet different STC requirements.
- All-sided panel's protective frames are made of standard, clear and natural anodized 6063-T5 architectural grade aluminium alloy.

Track & Carrier Suspension System

- The Aluminium Track Systems are made of clear natural anodized 6063-T6 architectural grade aluminum alloy.
- Different options of track intersections are available to suit specific design requirement.
- Options of single or dual carrier suspension to suit different stacking layout design and requirement.
- Each single suspension carrier has four vertical metal bearing wheels roll on the track. Each wheel has precision-ground 6002-2RS bearings, encased with POM, steel banded and reinforced. The double suspension carrier has two horizontal high grade polymer disks manoeuvre on straight or multi direction divert track layout.

Acoustic Seals

- Unique Vertical tongue and groove profile ensure panel-to-panel alignment as well as to prevent sound leaks between panel joints.
- Fast-set horizontal top & bottom retractable seals with 38mm nominal operation clearance between top track and bottom floor. The retractable seals provide ideal compression force to top track and bottom floor when the panel is locked in position to prevent sound travelling through the joints.

Panel Finishes

- Panels come in standard unfinished for on field decoration or options of factory applied finishes i.e. upholstery fabric, high pressure laminate (HPL), wallpaper, PVC laminate, glass, white-board and corkboard etc.

CLAZ Series



Designed for wall and ceiling below 6 meters with moderate acoustic performance up to STC 49. CLAZ is suitable for ballroom, meeting room, exhibition hall, and convention center, as well as rooms that require moderate to high acoustic reduction.

Panel Specifications

Thickness	85mm
Width	750mm ~ 1200mm
Height	1500mm ~ 6000mm
Acoustic Seal	Fast-Set Top & Bottom Retractable Seal
Acoustic Performance	STC 42 ~ 49 dB
Options	Single / Double Leaf Pass Door

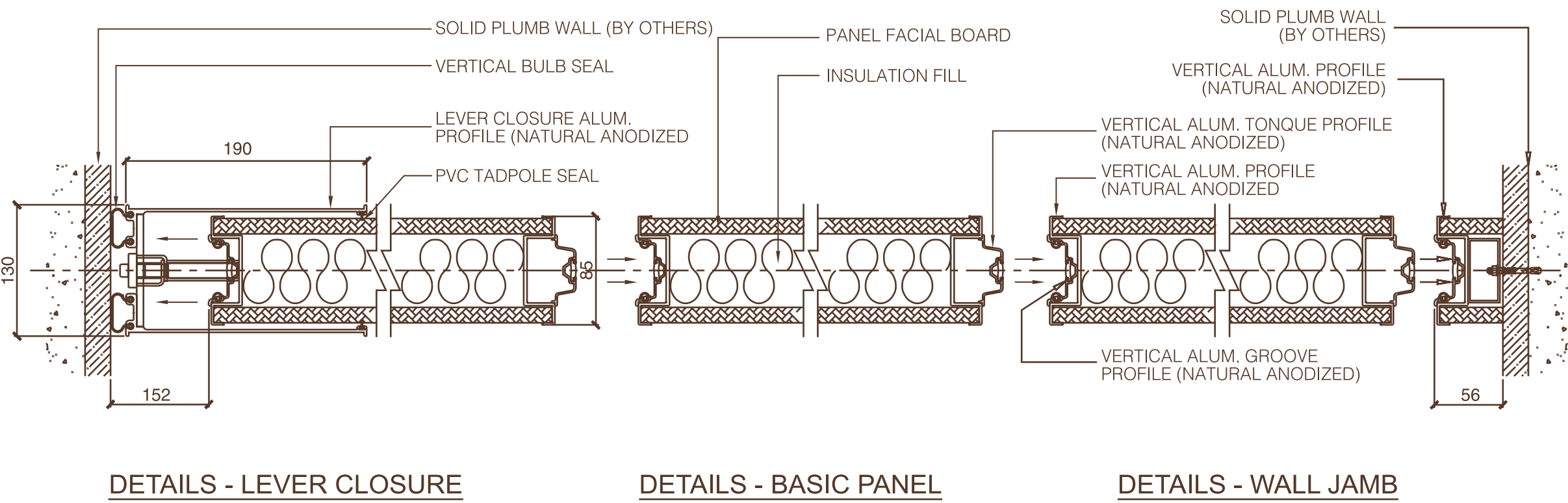
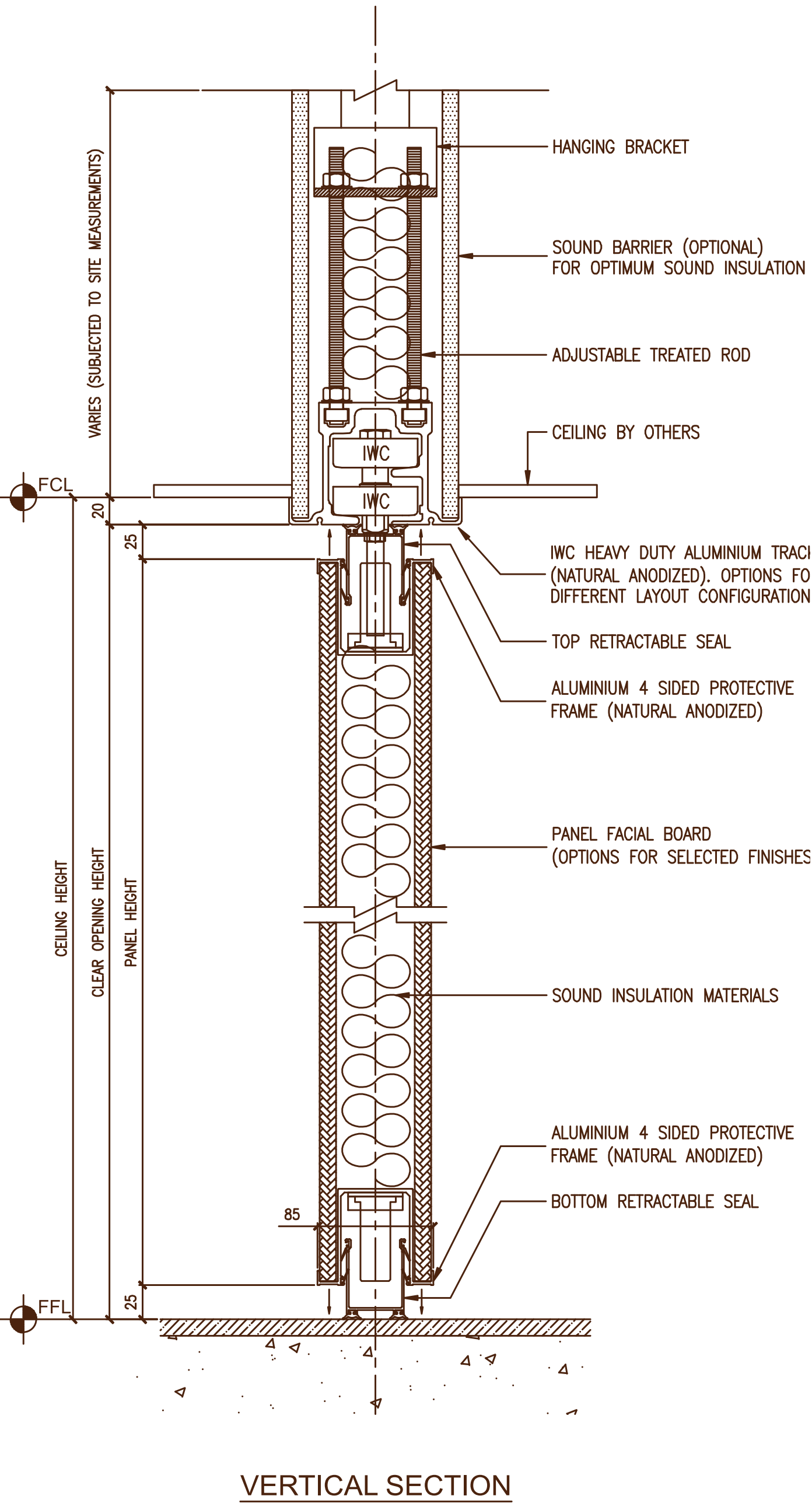

Track Options:
Type #D450, #S300

***IWC ASIA reserves the rights to change and improvise the product without prior notice.*

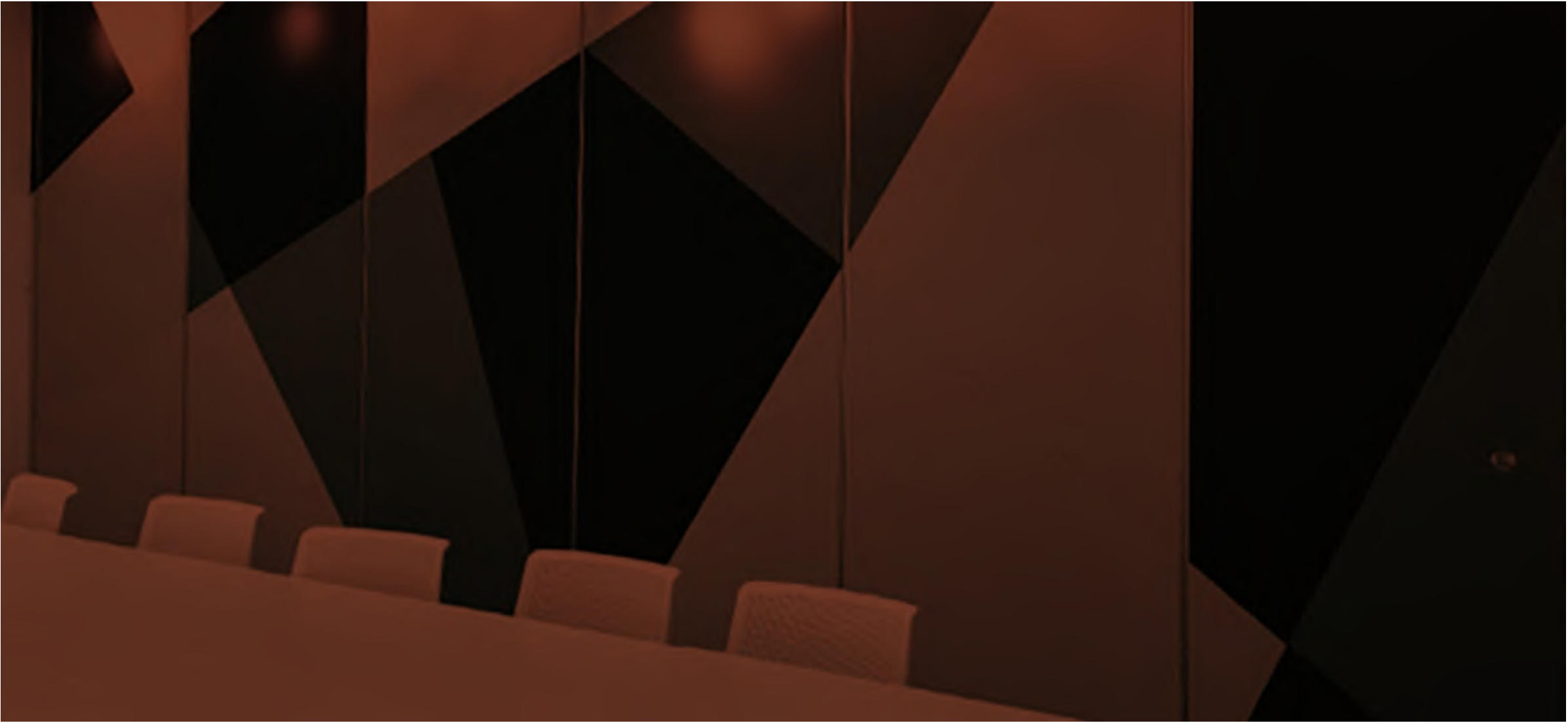



Panel Construction

- Panels' nominal thickness are 85mm thick.
- Face boards with options of 12mm thick particle board/Gypsum board/MDF board infilled with sound insulation materials and options of different surface substances to meet different STC requirements.
- All-sided panel's protective frames are made of standard, clear and natural anodized 6063-T5 architectural grade aluminium alloy.

Acoustic Seals

- Unique vertical tongue and groove profile ensure panel-to-panel alignment as well as to prevent sound leaks between panel joints.
- Fast-set horizontal top & bottom retractable seals with 25mm nominal operation clearance between top track and bottom floor. The retractable seals provide ideal compression force to top track and bottom floor when the panel is locked in position to prevent sound travelling through the joints.

Track & Carrier Suspension System

- The Aluminium Track Systems are made of clear natural anodized 6063-T6 architectural grade aluminum alloy.
- Different options of track intersections are available to suit specific design requirement.
- Options of single or dual carrier suspension to suit different stacking layout design and requirement.
- Each single suspension carrier has four vertical metal bearing wheels roll on the track. Each wheel has precision-ground 6002-2RS bearings, encased with POM, steel banded and reinforced. The double suspension carrier has two horizontal high grade polymer disks manoeuvre on straight or multi direction divert track layout.

Panel Finishes

- Panels come in standard unfinished for on field decoration or options of factory applied finishes i.e. upholstery fabric, high pressure laminate (HPL), wallpaper, PVC laminate, glass, white-board and corkboard etc.

ECOS Series



Designed for wall and ceiling below 6 meters with moderate acoustic performance up to STC 49. Suitable for basic room division usage such as VIP or private rooms in restaurants.

Panel Specifications

Thickness	66mm
Width	750mm ~ 1200mm
Height	1500mm ~ 3500mm
Acoustic Seal	Fast-Set Top & Bottom Retractable Seal
Acoustic Performance	STC 32 ~ 34 dB
Options	Single / Double Leaf Pass Door

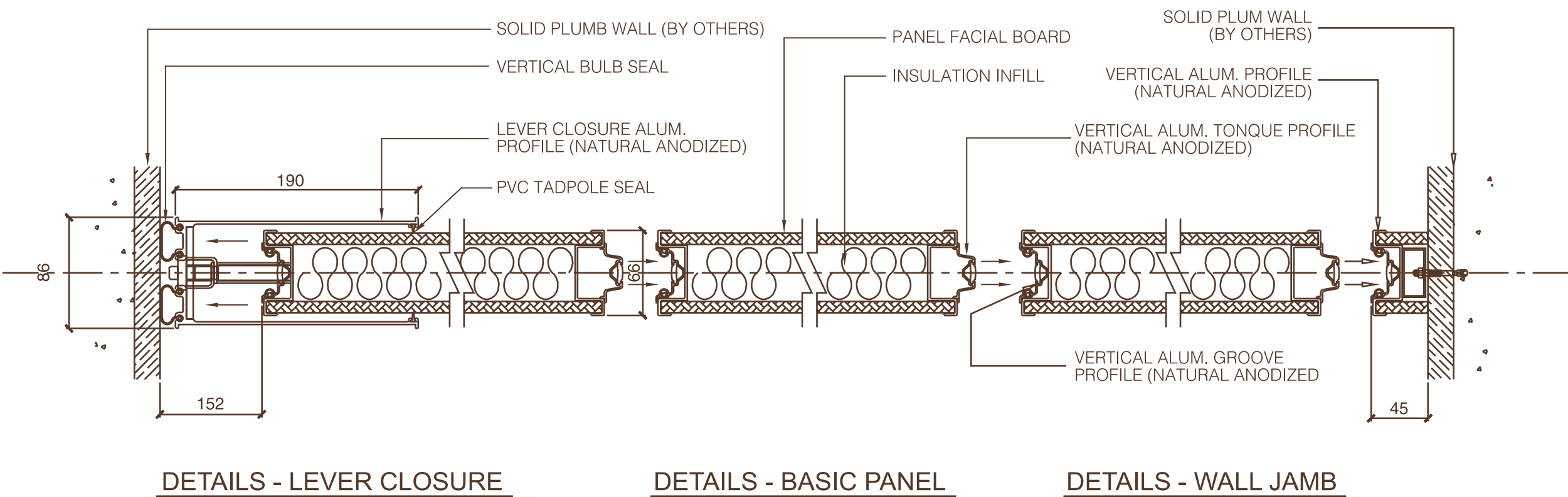
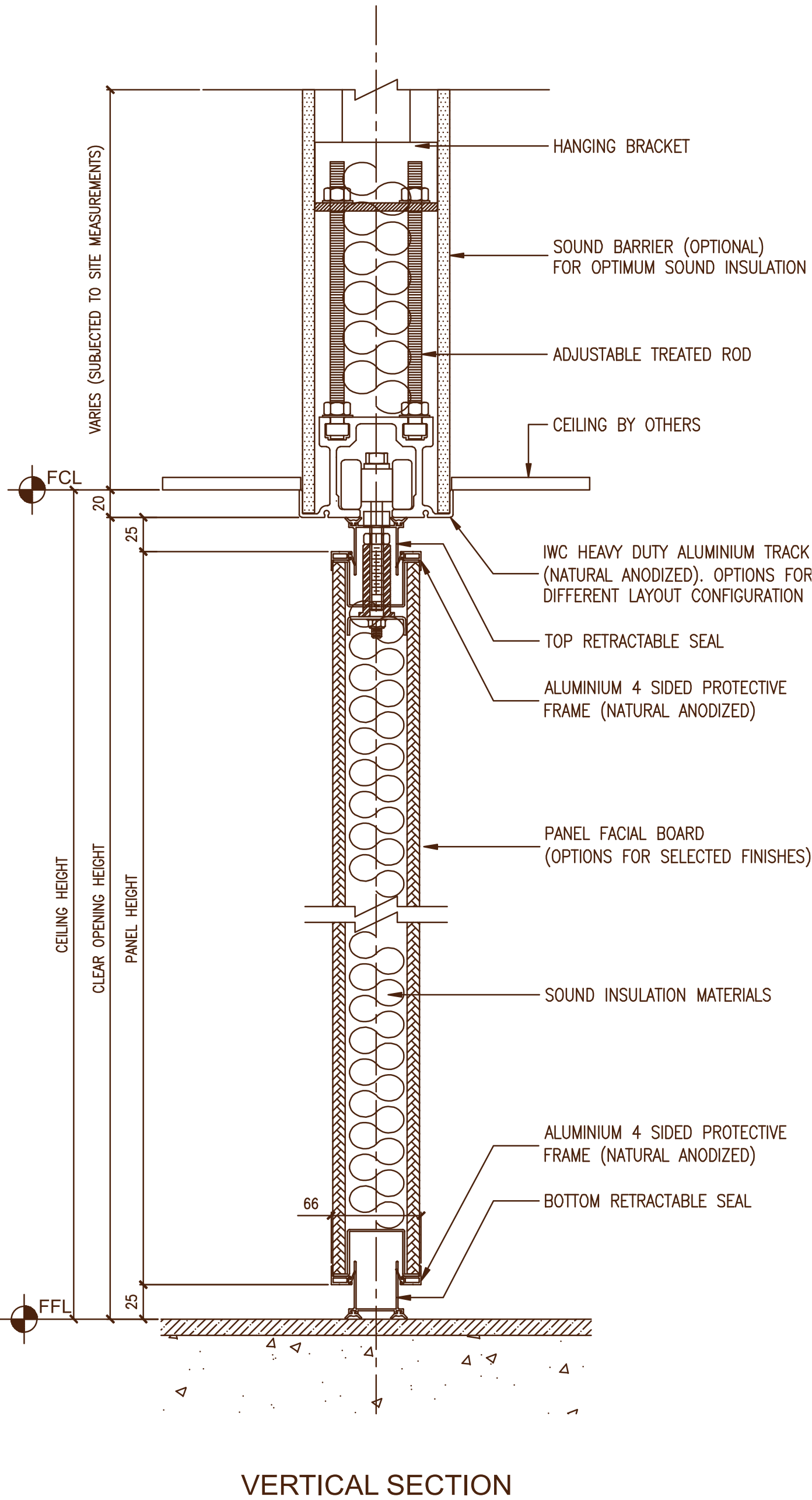

Track Options: Type #D230, #S300

***IWC ASIA reserves the rights to change and improvise the product without prior notice.*





Panel Construction

- Panels' nominal thickness are 66mm thick.
- Face boards with options of 9mm thick particle board/Gypsum board/MDF board infilled with sound insulation materials and options of different surface substances to meet different STC requirements.
- All-sided panel's protective frames are made of standard, clear and natural anodized 6063-T5 architectural grade aluminium alloy.

Track & Carrier Suspension System

- The Aluminium Track Systems are made of clear natural anodized 6063-T6 architectural grade aluminum alloy.
- Different options of track intersections are available to suit specific design requirement.
- Options of single or dual carrier suspension to suit different stacking layout design and requirement.
- Each single suspension carrier has four vertical metal bearing wheels roll on the track. Each wheel has precision-ground 6002-2RS bearings, encased with POM, steel banded and reinforced. The double suspension carrier has two horizontal high grade polymer disks manoeuvre on straight or multi direction divert track layout.

Acoustic Seals

- Unique vertical tongue and groove profile ensure panel-to-panel alignment as well as to prevent sound leaks between panel joints.
- Fast-set horizontal top & bottom retractable seals with 25mm nominal operation clearance between top track and bottom floor. The retractable seals provide ideal compression force to top track and bottom floor when the panel is locked in position to prevent sound travelling through the joints.

Panel Finishes

- Panels come in standard unfinished for on field decoration or options of factory applied finishes i.e. upholstery fabric, high pressure laminate (HPL), wallpaper, PVC laminate, glass, white-board and corkboard etc.



IWC ASIA Sdn. Bhd. (977269-X)

IWC Integrated Sdn. Bhd. (1168080V)

No. 99, Jalan KP7, Kawasan Perindustrian Kota Puteri,
48100 Batu Arang, Selangor, Malaysia.

Tel: +603-6087 0058

Email: sales@iwcasia.com.my

IWC/OW/2021-1

DISTRIBUTOR:

