

BEScube System

Besco Building Supplies (SEA) Pte Ltd
26 Ubi Road 4 The Besco Building Singapore 408613
t (65) 6286 0666 f (65) 6741 3430
sales@besco.sg www.besco.sg

Statements and recommendations provided by BESCO™ either communicated through publication or verbally are based on empirical data and experience acquired to date. Laminated LPL panels may be subjected to changes due to application methods, substrate variations and environmental conditions. Images appearing in our publication / website are meant to be used as reference materials. No liability may be derived from it as results may vary individually.

ARTEMIS:13.06.001



ARTEMIS

ARTEMIS has ascertained its unique character among all other Restroom Cubicle Systems. It is easy to see why this state-of-the-art system is always the choice of selection among its users. Mixture of different materials and design elements blends seamlessly into all models of ARTEMIS. Firmly anchored to the floor with all fixing details concealed; users will be amazed by the stability of this system.

ARTEMIS Accessories + Specifications + Drawings

Stainless Steel + Aluminium

General

BESCO[™] supply and install^{*} ARTEMIS Restroom Cubicle System, which is highly resistant against water, chemical and impact.

Materials

All accessories shall be made of stainless steel grade 304 and all hardware/ fittings shall be made of powder-coated aluminium grade 6063-T5. Anodised aluminium option is available upon request. The doors and intermediate partitions shall be 12mm thick High Pressure Laminates (HPL) compact board (or phenolic board) with chamfered edges.

HPL compact boards are manufactured from sheets of special kraft and decor papers, impregnated with thermosetting synthetic resins, fused together under heat and high pressure. HPL compact board has laminates on both sides with either matt finish or textured finish. The performance of the board is tested according to BS EN Standards and has the following rating:

- ▶ Boiling Water (EN438-7) : 8.4 (Within max. 11.5)
- ▶ Fire Rating (EN476-6/7) : Class 1 (meet min. 1)
- ▶ Impact (EN438-11) : 2.8 Newton (exceed min. 2.0)
- ▶ Stain (EN438-15) : 5 (exceed min. 4)
- ▶ Scratch (EN438-2) : 4 Newton (exceed min. 2.0)

It is a natural occurrence under various climatic conditions that HPL compact boards may undergo dimensional changes of tolerance differences within ±5mm.

HPL compact boards used in our systems are certified by Singapore Environment Council with Singapore Green Label.

Doors

All doors shall be of single colour, 12 mm thick HPL compact board with chamfered edge. Each will be supported by 3 Stainless Steel Hinges (4 Stainless Steel Hinges for Door width ≥ 750mm) affixed to the pilaster, completed with Stainless Steel Door Lock and Stainless Steel Coat Hook.

Pilasters

All pilasters shall be made of powder-coated aluminium grade 6063-T5, centre Pilaster - 202mm x 55mm x 6mm (cross-section dimension, W x D x Thk). End Pilasters - 101mm x 55mm x 6mm (cross-section dimension, W x D x Thk). Pilaster's front face is fitted with mirror/glass or HPL and powder-coated Metal Box-up. Anodised aluminium option is available upon request. All pilasters shall be anchored to the floor using aluminium Tall L-bracket and covered with a Metal Box-up. An acoustic Rubber Lining shall be incorporated to the pilasters for dampening out door banging noise.

Intermediate Partitions

All intermediate partitions shall be of same colour as door, 12mm thick HPL compact board with aluminium concealed U-channel, 27mm x 26.5mm x 1.2mm (cross-section dimension, L x W x Thk), affixed at its ends (to the wall and pilaster). To improve stability of the system, BESCO[™] recommends that length exceeding 1700mm to be fitted with an extra Pedestal or increase thickness to 19mm HPL compact board.

U-channel Cover

U-channel Cover is specially designed to conceal screw heads. It is easily installed by snap fitting onto the U-channel.

Accessories

Each restroom cubicle will be equipped with the following accessories:

- ▶ BESCO[™] Stainless Steel Lockset with round occupancy indicator.
- ▶ BESCO[™] Stainless Steel Coat Hook with rubber stopper allows loads up to 25kg.
- ▶ BESCO[™] Stainless Steel Hinges with cover, adjustable from fully close to open at interval of 15°.

Compartment's Dimension

The recommended restroom cubicle size:

850 - 900mm by 1500 - 1800mm by 1930mm (W x D x H).

- ▶ Visible height of restroom compartment measured from top of pilaster to floor is 1930mm.
- ▶ Door size shall be between 600mm - 750mm in width.
- ▶ Door size shall be between 900 mm - 1000 mm in width for ambulant restroom.

Finishes

HPL compact boards are available in a variety of brilliant colours, woodgrains and tactile patterns. For surface finishes, you have the choices of matt or glossy. New 'MicroDot' tactile finish is available upon request.

Installation

Installation will be executed under the supervision of BESCO[™]'s site supervisor(s) and shall be carried out in accordance with BESCO[™] installation instructions.

Accessories

01. SS Lock Set (w/round occupancy indicator)
02. SS Long Lock Set (w/occupancy indicator)
03. SS Coat Hook (w/cover)
- 04a. SS Hinges (w/cover - Left)
- 04b. SS Hinges (w/cover - Right)
- 04b. SS Ambulant Hinge
05. End Pilaster (w/latch)
06. Centre Pilaster
07. End Pilaster
- 08a. Metal Box-up (centre pilaster)
- 08b. Metal Box-up (end pilaster)
- 09a. Latch Rubber Lining
- 09b. Door Stopper Rubber Lining
10. Concealed U-channel
- 11a. Aluminium Tall L-bracket (centre pilaster)
- 11b. Aluminium Tall L-bracket (end pilaster)

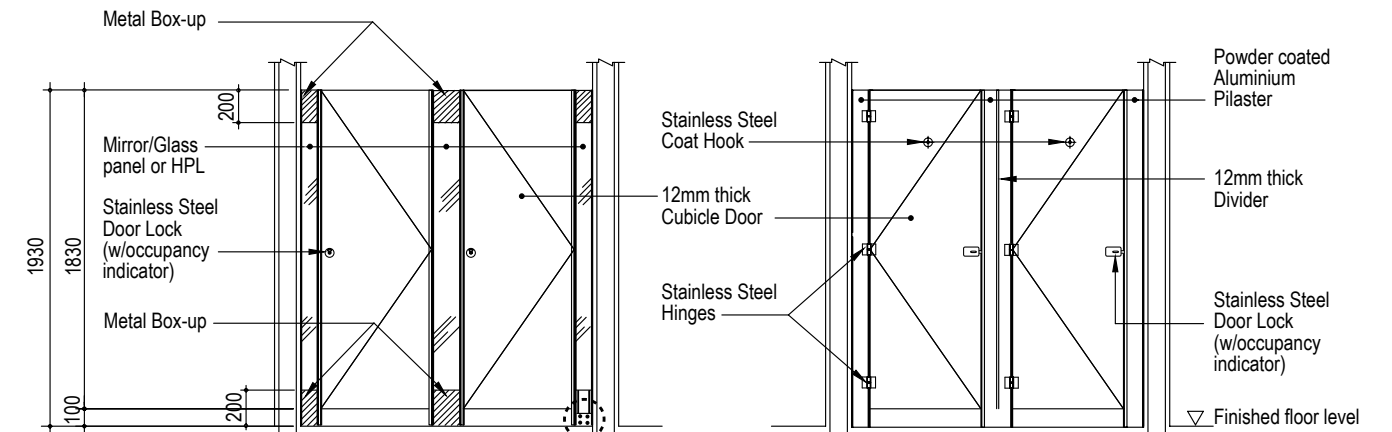

Elevation 1

Elevation 2

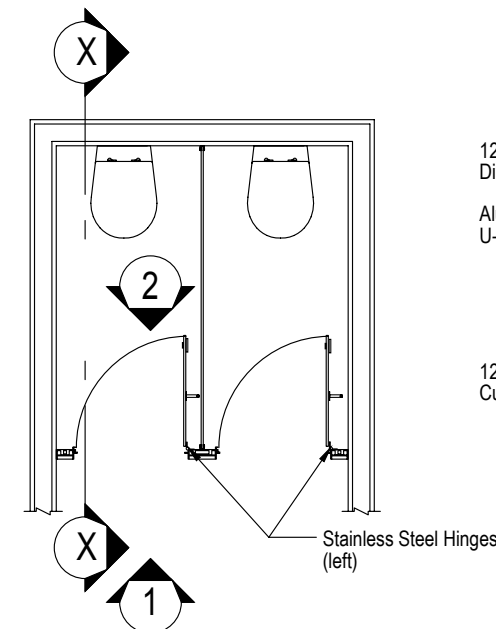

Layout Plan of Restroom Cubicle

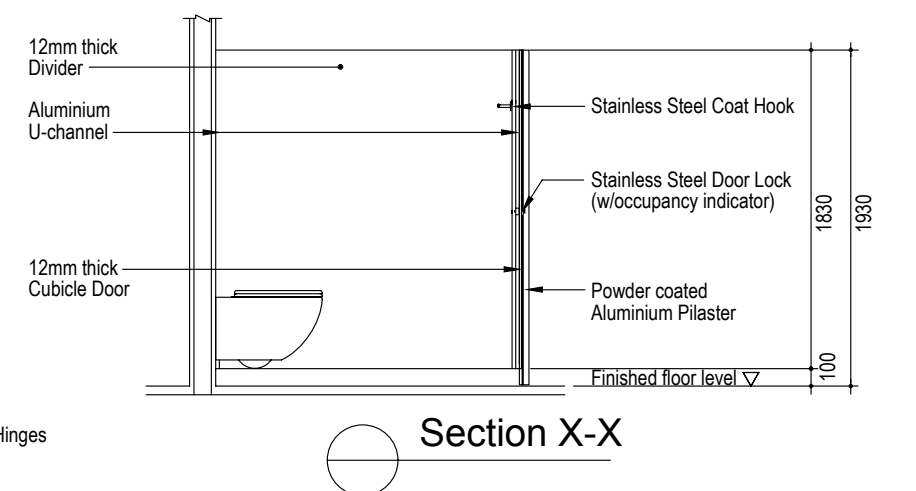

Section X-X

Optional:
Jumbo Roll Holders

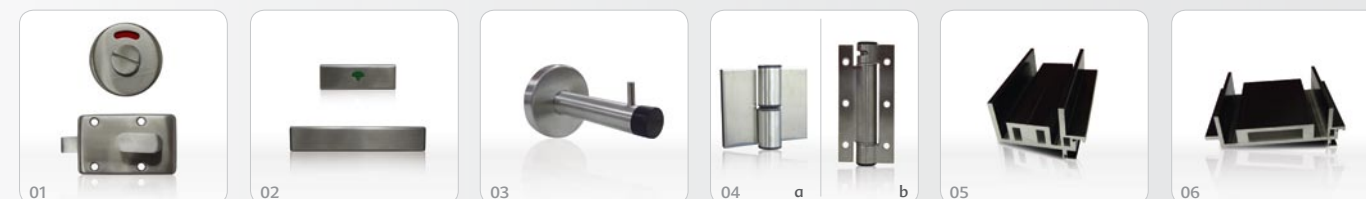

- ▶ SS accessories in grade 304.
- ▶ SS Hinges - normal is available upon request.
- ^{*}Please check with your local distributors for more information.

